

## TUERCA ALTA

High nuts  
Écroux

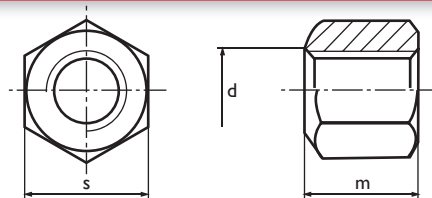

**DIN 6330 B** Material: Tratado / Heat treated steel



Ref.	d (mm)	m (mm)	s (mm)
3000	M-6	8	9
3001	M-8	12	13
3002	M-10	15	17
3003	M-12	18	19
3004	M-14	21	22
3005	M-16	24	24
3006	M-18	27	27
3007	M-20	30	30

Ref.	d (mm)	m (mm)	s (mm)
3008	M-22	33	32
3009	M-24	36	36
3010	M-27	40	41
3011	M-30	45	46
30115	M-36	54	55
301151	M-42	63	65
301152	M-48	72	75

## TUERCA CON COLLARÍN

Flanged nuts  
Écroux à embase



**DIN 6331** Material: Tratado / Heat treated steel

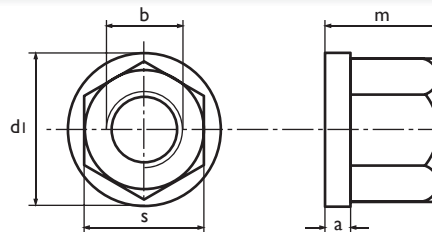

Ref.	d (mm)	s (mm)	m (mm)	d1 (mm)	a (mm)
3012	M-6	10	9	14	3
3013	M-8	13	12	18	3,5
3014	M-10	17	15	22	4
3015	M-12	19	18	25	4
3016	M-14	22	21	28	4,5
3017	M-16	24	24	31	5
3018	M-18	27	27	34	5
3019	M-20	30	30	37	6

Ref.	d (mm)	s (mm)	m (mm)	d1 (mm)	a (mm)
3020	M-22	32	33	40	6
3021	M-24	36	36	45	6
3022	M-27	41	40	51	8
3023	M-30	46	45	58	8
30235	M-36	55	54	68	10
302351	M-42	65	63	80	12
302352	M-48	75	72	92	14

## TUERCA DE PROLONGACIÓN

Extension nuts  
Écroux allonges



**DIN 6334** Material: Tratado / Heat treated steel

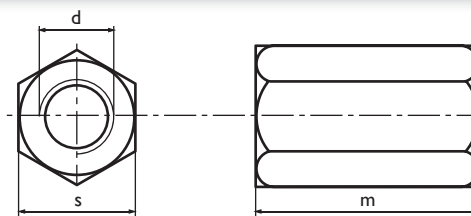

Ref.	d (mm)	s (mm)	m (mm)
3024	M-6	10	18
3025	M-8	13	24
3026	M-10	17	30
3027	M-12	19	36
3028	M-14	22	42
3029	M-16	24	48
3030	M-18	27	54
3031	M-20	30	60

Ref.	d (mm)	s (mm)	m (mm)
3032	M-22	32	66
3033	M-24	36	72
3034	M-27	41	81
3035	M-30	46	90
3036	M-36	55	108
3037	M-42	65	126

Solicite precio para todo tipo de tuercas especiales